

Villa



Porch

Terrace

Solarium

Basement



1	433,08	141,5 m2	3	4	17	9,5	52,5	83,5	2026	780.000,00 €
2	354,56	141,5 m2	3	4	17	9,5	52,5	92,8	2026	729.000,00 €
3	367,33	141,5 m2	3	4	17	9,5	52,5	96,7	2026	RESERVED
4	377,84	141,5 m2	3	4	17	9,5	52,5		2026	RESERVED
5	380,89	141,5 m2	3	4	17	9,5	52,5		2026	RESERVED
6	383,34	141,5 m2	3	4	17	9,5	52,5		2026	RESERVED
7	385,65	141,5 m2	3	4	17	9,5	52,5		2026	650.000,00 €
8	380,86	141,5 m2	3	4	17	9,5	52,5		2026	650.000,00 €
9	372,33	141,5 m2	3	4	17	9,5	52,5		2026	635.000,00 €
10	363,47	141,5 m2	3	4	17	9,5	52,5		2026	RESERVED
11	350,21	141,5 m2	3	4	17	9,5	52,5		2026	615.000,00 €
12	334,39	141,5 m2	3	4	17	9,5	52,5		2026	605.000,00 €
77	318,16	141,5 m2	3	4	17	9,5	52,5		2026	RESERVED
14	338,86	141,5 m2	3	4	17	9,5	52,5		2026	RESERVED

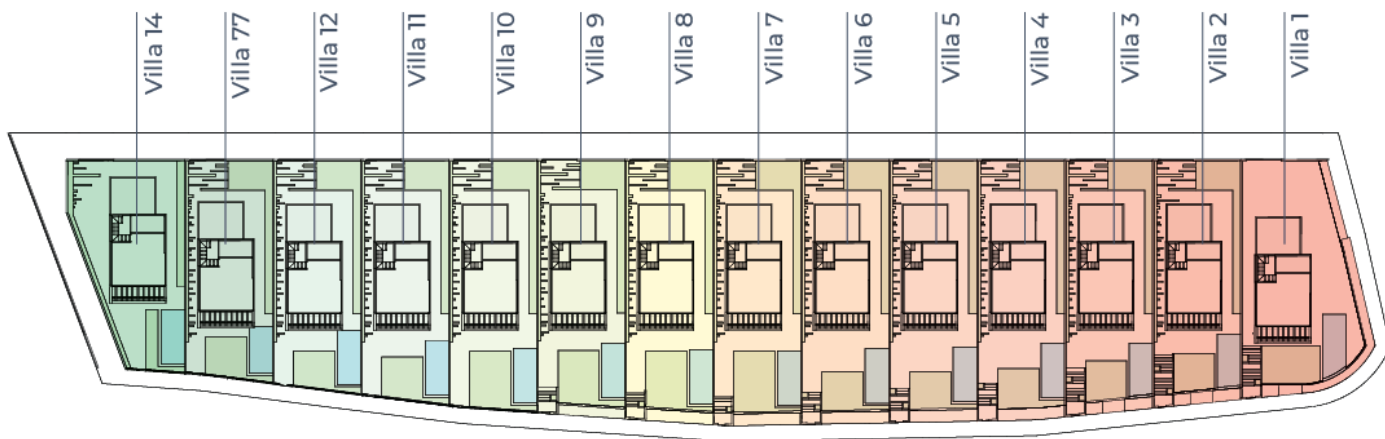

INCLUDED

- Kitchen with appliances
- Swimming pool 7 x 3 m
- Fully furnished bathrooms
- Air conditioning preinstallation
- Electric blinds
- Garden and plot according to the plan

NOT INCLUDED

- Furniture
- Basement are diaphanous
- Air conditioning machines
- Extra plants and tiles
- VAT 10%
- Extras are available at request

* All surfaces may change depending the project